

WILLIAM STREET

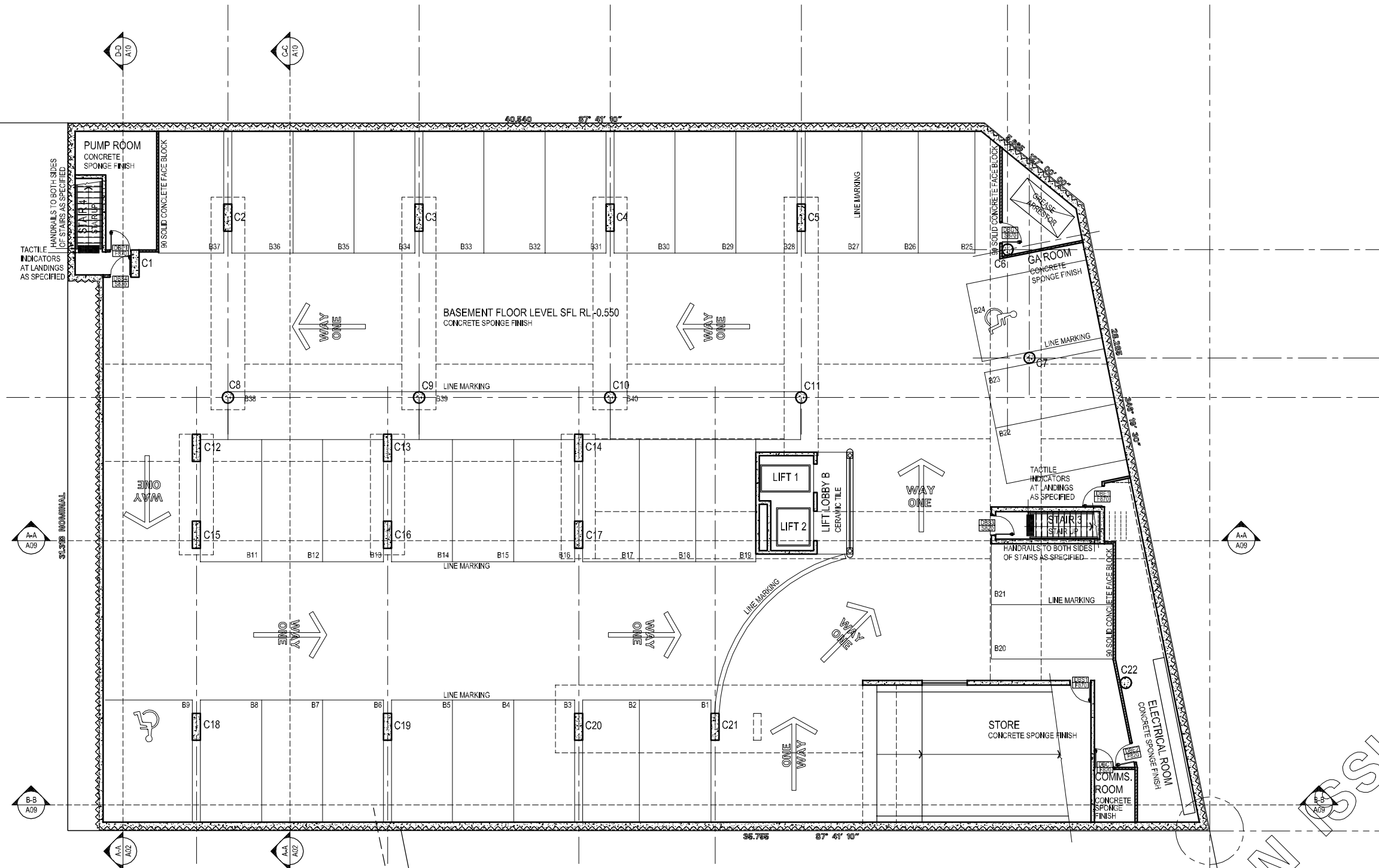

BASEMENT FLOOR PLAN
 SCALE 1:100@A1 SIZE SHEET
 GROSS FLOOR AREA - 1435.65m²

SHORT STREET

No.	DATE	DESCRIPTION	BY
D	04.200	CONSTRUCTION ISSUE	R.L.
C	24.050	TENDER 2 ISSUE	R.L.
B	18.04.05	PHASING LAYOUT AMENDED, COLUMN NUMBERS ADDED	R.L.
A	20.04.05	TENDER ISSUE	R.L.

- NOTES**
- CHECK ALL DIMENSIONS ON SITE BEFORE COMMENCING ANY PART OF THE WORKS.
 - REPORT ALL DISCREPANCIES TO THE ARCHITECT FOR A DECISION BEFORE PROCEEDING WITH THE WORK.
 - WORK TO FIGURED DIMENSIONS. DO NOT SCALE DRAWINGS.
 - THIS DRAWING IS TO BE READ IN CONJUNCTION WITH ALL OTHER RELEVANT SPECIFICATIONS AND DRAWINGS.
 - THIS DRAWING IS COPYRIGHT AND MUST NOT BE REPRODUCED, REPRODUCED OR USED WHOLLY OR IN PART WITHOUT AUTHORITY FROM THE ARCHITECTS.
 - THE SCALE OF THIS DRAWING MAY BE AFFECTED BY ENLARGEMENT OR REDUCTION DURING TRANSMISSION. CHECK SCALE AGAINST GRAPHIC BAR SCALE.

McNeil Ellis Architects

P.O. BOX 363 (94 WILLIAM ST)
 PORT MACQUARIE NSW 2444
 TEL: (02) 6561 5211 FAX: (02) 6561 5216
 EMAIL: [mea@mea.com.au](mailto:info@mea.com.au)
 WEB: www.mneil.com.au

DIRECTORS & CHARTERED ARCHITECTS:
 MALCOLM HARRIS, BArch, AArchA
 WYNNE ELLIS, BArch, AArchA

CLIENT:
 LLOYD PROPERTY DEVELOPMENTS
 25 - 27 HAY STREET
 PORT MACQUARIE

PROJECT:
 QUAYSIDE STAGE 1
 MOTEL & COMMERCIAL COMPLEX
 LOT 17 DP 527171, 136 WILLIAM ST.,
 PORT MACQUARIE

DRAWING:
 BASEMENT FLOOR PLAN

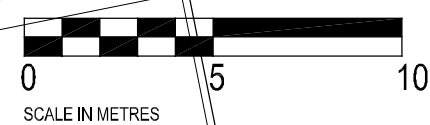

PROJ. No **0164** DWG No. **A03/d**
 DRAWN **RL**
 DATE **08.11.04**
 CHECKED
 SCALE **1:100@A1 SIZE SHEET**
 COMP. REF. :01ARCH\HV0164\0164A03basement.dwg

CONSTRUCTION ISSUE

01.12.05